

1. 6:00 P.M. Coppermine - Edgewood

<b>Meeting Date/Time:</b>	<b>Monday, January 11, 2021 at 6:00 pm</b>
<b>Meeting Location:</b>	<p style="text-align: center;">Coppermine Community Input Meeting Please join the meeting from your computer, tablet or smartphone.</p> <p style="text-align: center;"><a href="https://global.gotomeeting.com/join/243200749">HTTPS://GLOBAL.GOTOMEETING.COM/JOIN/243200749</a> Password: CoppermineCIM</p> <p style="text-align: center;">You can also dial in using your phone. United States: +1 (646) 749-3112 Access Code: 243-200-749</p>
<b>Location of Proposed Development:</b>	Tax Map 65, Parcels 1064 & 245 located on Cedar Drive in Edgewood. The subject property is west of Edgewood Elementary School and west of the Boys & Girls Club on Cedar Drive.
<b>Description of Proposed Development:</b>	Proposed development of 8 athletic fields with building for concessions, events space, restrooms. Associated infrastructure to include sidewalks, parking, utilities and stormwater management. The site totals 35.04 acres and is zoned R4.
<b>Applicant:</b>	Morris & Ritchie Associates, Inc.
<b>Contact:</b>	Daniel Spiker at Morris & Ritchie Associates, Inc. at (410) 515-9000.

Documents:

[CEDAR DRIVE 1-11-21.PDF](#)

PLAN TYPE: CIVIL  
 PLAN NO: 1240-2000  
 VERSION: 1  
 DATE: 11-1-20  
 DRAWN BY: 285-2A

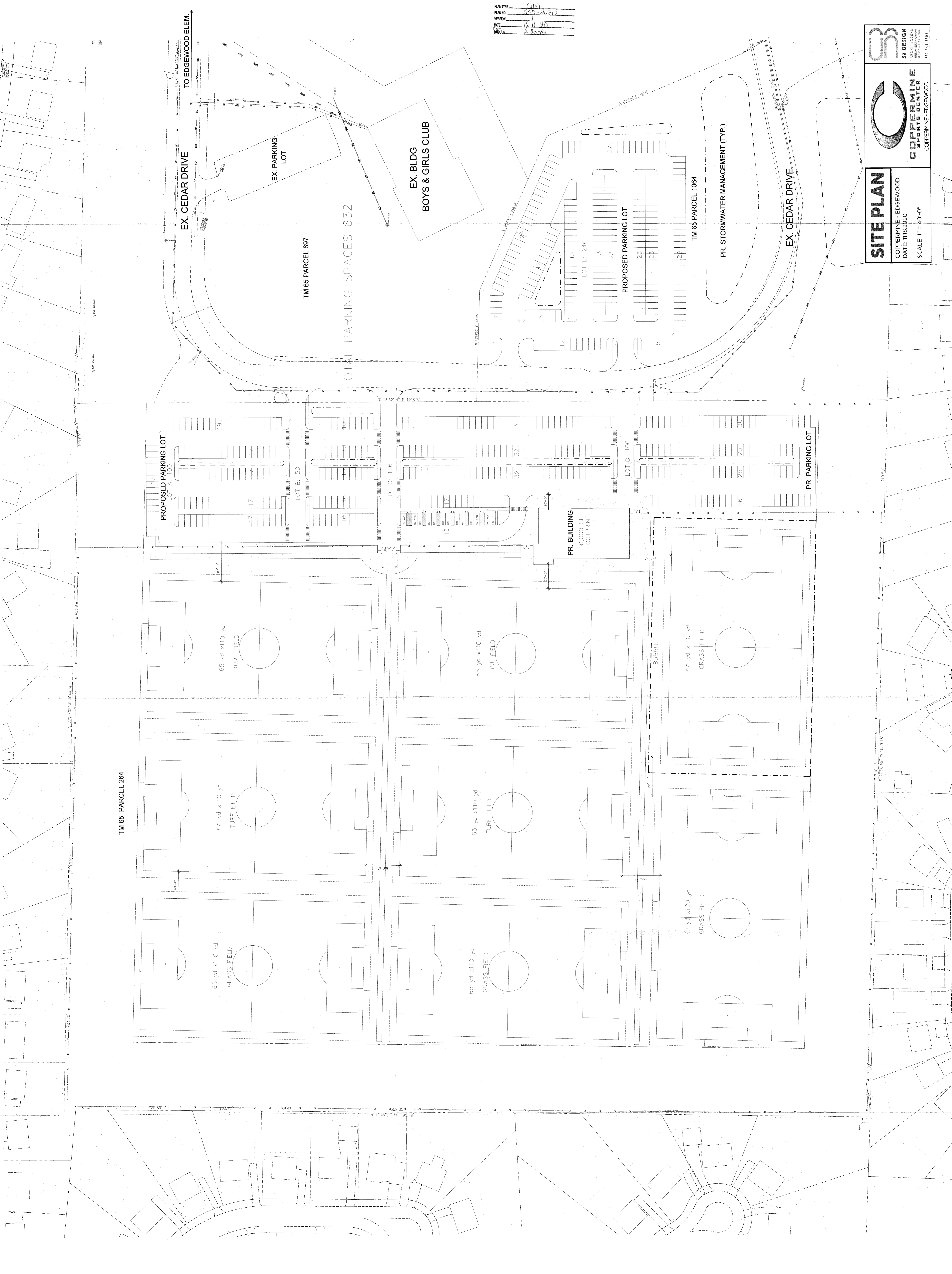

**SITE PLAN**  
 COPPERMINE - EDGEWOOD  
 DATE: 11B.2020  
 SCALE: 1" = 40'-0"  
  
**COPPERMINE SPORTS CENTER**  
 COPPERMINE - EDGEWOOD  
 SS DESIGN  
 731.244.1874