

**SOILS DATA:**

MAP SYMBOL	MAP UNIT NAME	HYDROLOGIC GROUP
R4D	RUSSETT FINE SANDY LOAM	C
R4D	RUSSETT FINE SANDY LOAM	C

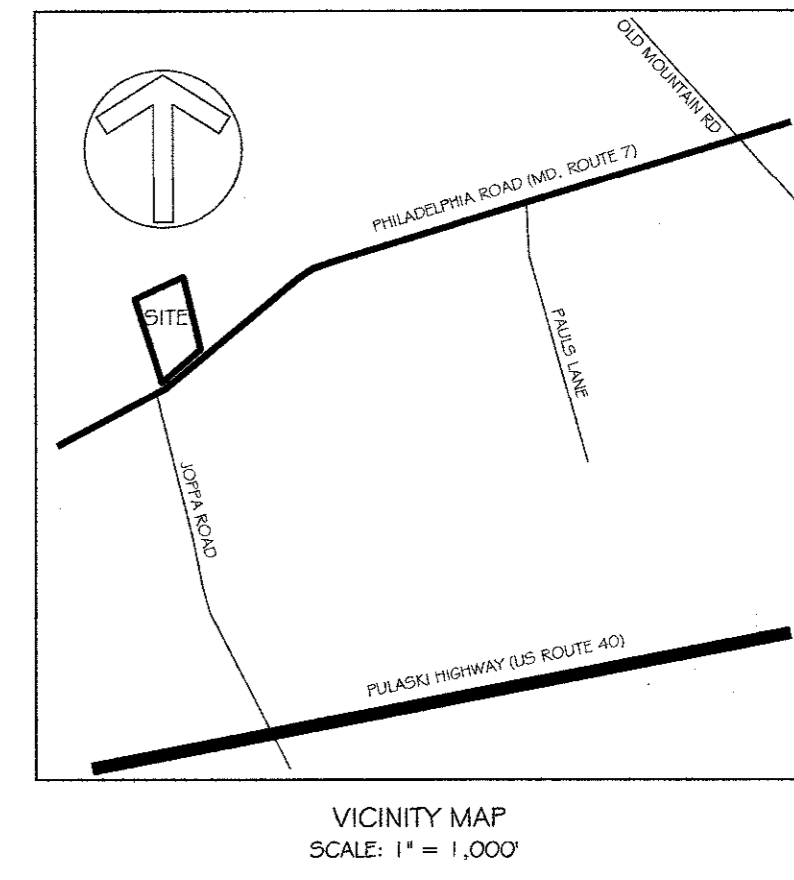

- SITE DATA:**
- 1) OWNER: 608 PHILADELPHIA, LLC
  - 2) CONTACT ADDRESS: 7215 SUNSHINE AVENUE, KINGSVILLE, MD 21087
  - 3) CONTACT TELEPHONE NO.: 410-592-5326
  - 4) DEED REFERENCE: 8010486
  - 5) TAX ACCOUNT NUMBER: 050443
  - 6) TAX MAP: 65 PARCELS 2A, 832
  - 7) ZONING: LIGHT INDUSTRIAL
  - 8) ZONING MAP: 65
  - 9) ELECTION DISTRICT: 104
  - 10) AREA OF TRACT: 2.49 ACRES
- 11) USE:**  
 EXISTING: RESIDENTIAL  
 PROPOSED: RESIDENCE (CARETAKER) & SERVICE (ELECTRICAL CONTRACTOR STORAGE YARD & OFFICE)
- 12) THERE ARE NO KNOWN HISTORIC STRUCTURES NOR RARE, THREATENED AND ENDANGERED SPECIES ON THIS SITE.**
- 13) THE PROPERTY DOES NOT LIE WITHIN THE CBCA.**
- 14) THE CONTOURS LINE SHOWN HEREON ARE DERIVED FROM HARBORD COUNTY GIS DATA.**
- 15) WATER AND SEWER: PUBLIC**
- 16) BUILDING SETBACKS (IF SERVICE):**  
 FRONT: 25 FEET MIN.  
 ADJACENT RESIDENTIAL LOT: 25 FEET MIN.  
 SIDE: 10 FEET MIN.  
 REAR: 40 FEET MIN.
- 17) IMPERVIOUS SURFACE DATA:**  
 EXISTING: 7,160 SQ. FT.  
 REMOVED EXISTING: 3,782 SQ. FT.  
 PROPOSED NEW: 8,797 SQ. FT.  
 TOTAL: 12,175 SQ. FT. / 11.2%  
 TOTAL ALLOWED: 92,195 SQ. FT. / 85%
- 18) BUILDING LOT COVERAGE:**  
 EXISTING: 1,427 SQ. FT.  
 PROPOSED: 2,400 SQ. FT.  
 TOTAL: 3,827 SQ. FT. / 3.55%  
 TOTAL ALLOWED: 59,635 SQ. FT. / 55%
- 19) PARKING:**  
 RESIDENTIAL:  
 REQUIRED: 2 SPACES  
 PROPOSED: 2 SPACES  
 SERVICE:  
 REQUIRED: 6 SPACES (LARGEST EMPLOYEE / SHIFT)  
 PROPOSED: 10 SPACES (INCLUDES 1 HANDICAP)
- 20) THERE ARE NO KNOWN BOARD OF APPEALS CASES ASSOCIATED WITH THE SUBJECT PROPERTY.**
- 21) FREESTANDING WALL SIGNS: 2' x 5' EA. (10 SQ. FT. EA.)**

- LEGEND:**
- SOIL DEMARCATION LINE
  - SOIL MAP SYMBOL
  - ZONING DEMARCATION LINE
  - PROP. CONTOURS
  - EX. CONTOURS
  - WETLANDS
  - PROP. WOODS LINE
  - EX. WOODS LINE
  - SANITARY SEWER MANHOLE
  - CLEAN OUT
  - UTILITY POLE
  - SPECIMEN TREE

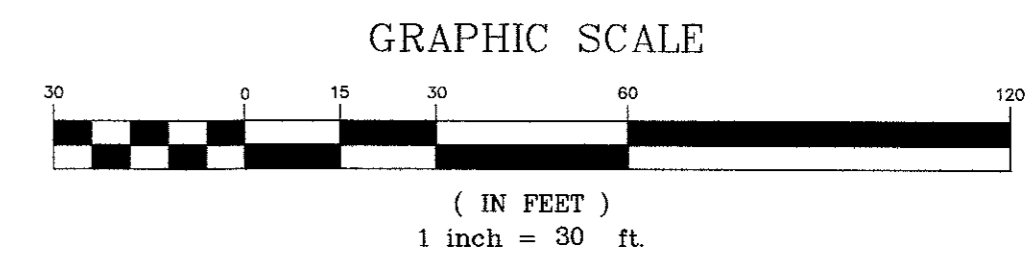

**kjwellsinc**  
 7403 NEW CLUT ROAD  
 KINGSVILLE, MARYLAND 21087  
 (410) 592-9800

Land Surveying, Site Planning & Landscape Architecture

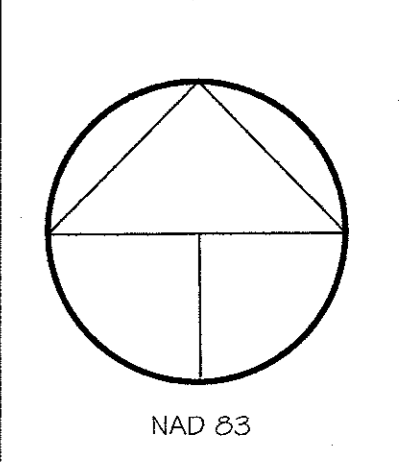
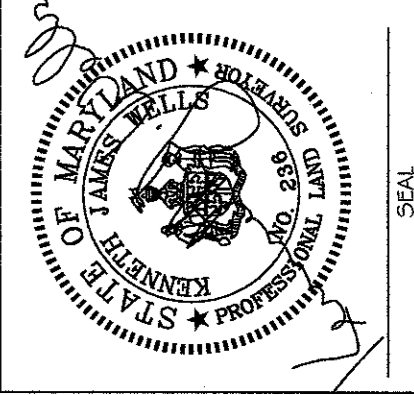

**REVISIONS:**

NO.	DATE

SITE PLAN  
 608 PHILADELPHIA ROAD  
 HARBORD COUNTY  
 MARYLAND  
 DISTRICT 1

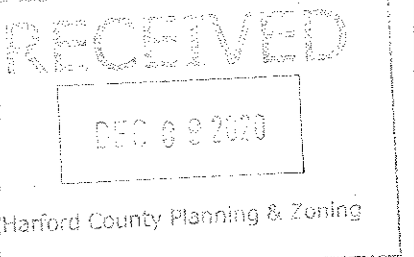

DRAWN BY: CAV/KJW  
 CHECKED BY: KJW  
 DATE: 4/2/2019  
 PROJECT NO.: 2014-056  
 SHEET 1 OF 1