

**LEGEND**

- EXISTING**
- PROPERTY LINE
  - BUILDING SETBACK
  - EX. 2' CONTOUR
  - EX. 10' CONTOUR
  - EX. CURB & GUTTER
  - EX. STORM DRAIN
  - EX. OVERHEAD WIRE
  - EX. WATERLINE
  - EX. SANITARY
  - EX. GAS LINE
  - EX. EDGE OF P.V.M.T.
  - EX. PAVING TO REMAIN
  - EX. CONCRETE
- PROPOSED**
- PR. 2' CONTOUR
  - PR. 10' CONTOUR
  - PR. COVENTRY CURBSTONE
  - PR. SANITARY
  - PR. STORM DRAIN
  - PR. WATER LINE
  - PR. PAVEMENT
  - PR. CONCRETE

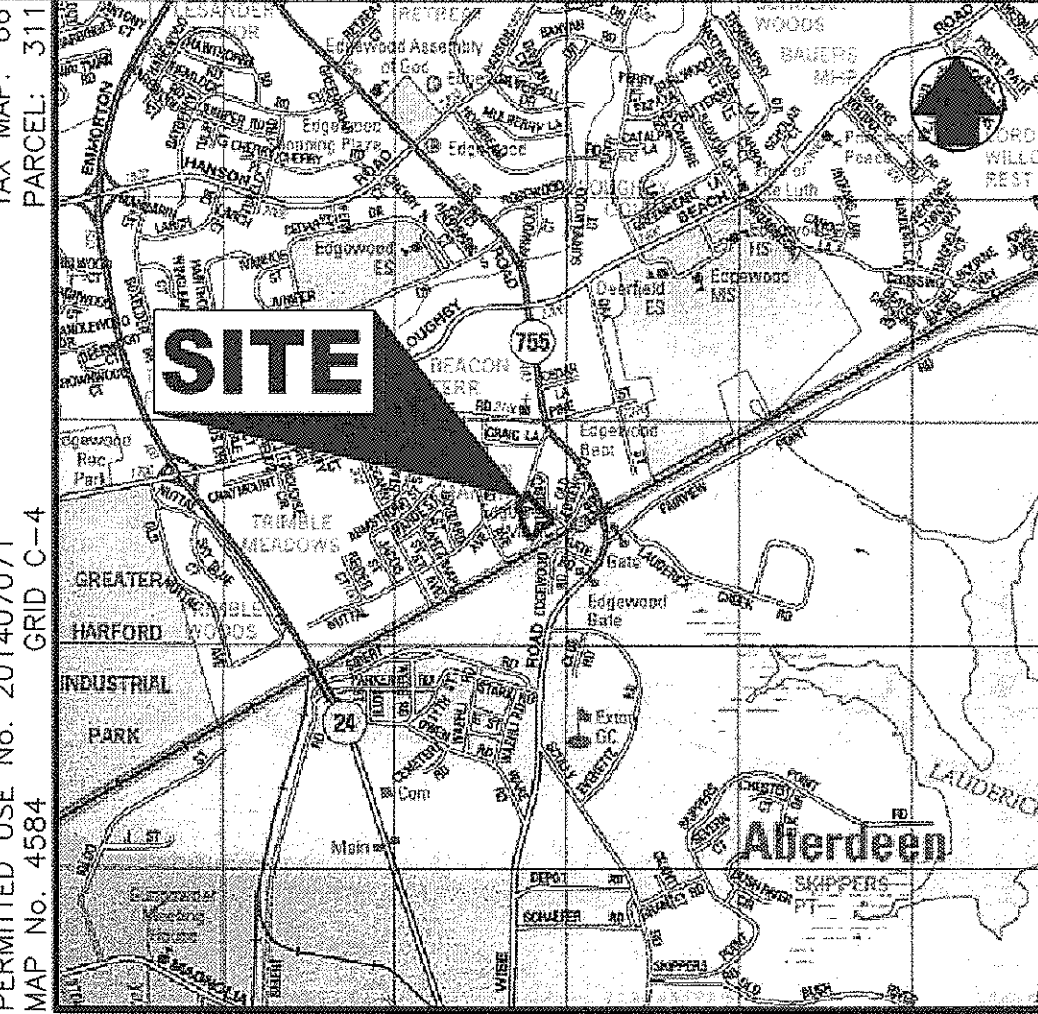
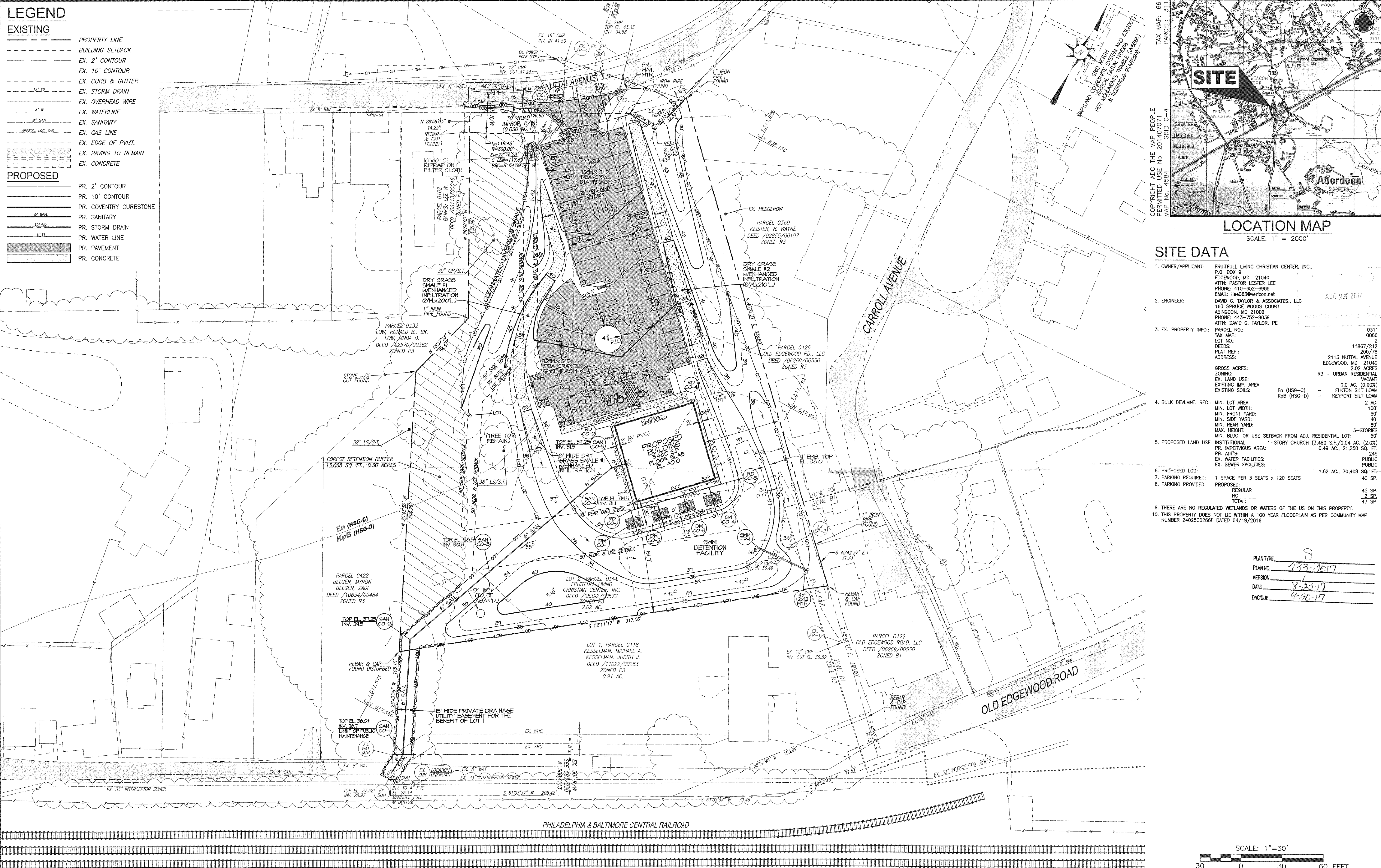

**LOCATION MAP**  
SCALE: 1" = 2000'

**SITE DATA**

- OWNER/APPLICANT: FRUITFUL LIVING CHRISTIAN CENTER, INC.  
P.O. BOX 9  
EDGEWOOD, MD 21040  
ATTN: PASTOR LESTER LEE  
PHONE: 410-652-6969  
EMAIL: lee063@verizon.net
- ENGINEER: DAVID G. TAYLOR & ASSOCIATES, LLC  
183 SPRUCE WOODS COURT  
ABINGDON, MD 21009  
PHONE: 443-752-9039  
ATTN: DAVID G. TAYLOR, PE
- EX. PROPERTY INFO:
 

TAX MAP NO.:	0311
LOT NO.:	0066
DEEDS:	11867/212
PLAT REF.:	200/78
ADDRESS:	2113 NUTTAL AVENUE
GROSS ACRES:	2.02 ACRES
EX. LAND USE:	VACANT
EXISTING IMP. AREA:	0.0 AC. (0.00%)
EXISTING SOILS:	En (HSG-C) - ELKTON SILT LOAM
	KpB (HSG-D) - KEYPORT SILT LOAM
- BULK DEVLMT. REG.:
 

MIN. LOT AREA:	2 AC.
MIN. LOT WIDTH:	100'
MIN. FRONT YARD:	50'
MIN. SIDE YARD:	40'
MIN. REAR YARD:	50'
MAX. HEIGHT:	3-STORIES
MIN. BLDG. OR USE SETBACK FROM ADJ. RESIDENTIAL LOT:	50'
- PROPOSED LAND USE: INSTITUTIONAL 1-STORY CHURCH (3,480 S.F./0.04 AC. (2.0%))  
PR. IMPERVIOUS AREA: 0.49 AC., 21,250 SQ. FT.  
AD'S: 245  
EX. WATER FACILITIES: PUBLIC  
EX. SEWER FACILITIES: PUBLIC
- PROPOSED LOD: 1.62 AC., 70,408 SQ. FT.
- PARKING REQUIRED: 1 SPACE PER 3 SEATS x 120 SEATS 40 SP.
- PARKING PROVIDED: PROPOSED  
REGULAR 45 SP.  
HC 2 SP.  
TOTAL 47 SP.
- THERE ARE NO REGULATED WETLANDS OR WATERS OF THE US ON THIS PROPERTY.
- THIS PROPERTY DOES NOT LIE WITHIN A 100 YEAR FLOODPLAIN AS PER COMMUNITY MAP NUMBER 240250266 DATED 04/19/2016.

PLANTYPE: S  
PLAN NO.: 433-AD17  
VERSION: 1  
DATE: 8-23-17  
DACQUE: 9-20-17

SCALE: 1" = 30'  
30 0 30 60 FEET

DATE	REVISIONS

DATE	REVISIONS

PROFESSIONAL CERTIFICATION  
I HEREBY CERTIFY THAT THESE DOCUMENTS WERE PREPARED OR APPROVED BY ME, AND THAT I AM A DULY LICENSED PROFESSIONAL ENGINEER UNDER THE LAWS OF THE STATE OF MARYLAND, LICENSE NO. 19220, EXPIRATION DATE: 08-03-2019.



**David G. Taylor & Associates, LLC**  
163 Spruce Woods Court  
Abingdon, MD 21009  
Cell: (443) 752-9039  
Email: dgtaylor@comcast.net

**DAC SITE PLAN**  
FOR  
**FRUITFUL LIVING CHRISTIAN CENTER CHURCH**  
2113 NUTTAL AVENUE  
TAX MAP 0066, GRID 0004A, PARCEL 0311

3rd ELECTION DISTRICT  
HARFORD COUNTY, MARYLAND

JOB NO.:	0048
SCALE:	AS NOTED
DATE:	08/22/17
DRAWN BY:	CRK
DESIGN BY:	DGT
REVIEW BY:	DGT
SHEET:	1 OF 1